



Clinical accessories portfolio

## CARESCAPE Ventilator R860



# EXHALATION VALVE

The flow sensor is one of the most important components of your critical care ventilator. It automatically checks patient airway flow and pressure 250 times per second, making it the “eye” of your ventilator.

The CARESCAPE™ R860 flow sensor and exhalation valve assembly (EVA) are available in both single patient use and reusable options.



## SINGLE PATIENT USE FLOW SENSOR AND EXHALATION VALVE ASSEMBLY

PRODUCT	PART NUMBER	QUANTITY
Whole Assembly (Housing and flow sensor)	1505-3848-001	1
	1505-3848-010	10
Housing only (includes water trap and membrane)	1505-8568-001	1
	1505-8568-010	10
Flow sensor only	1505-3231-001	1
	1505-3231-010	10

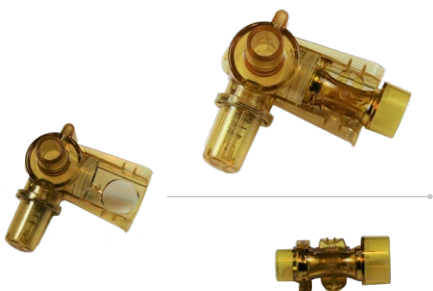

## REUSABLE FLOW SENSOR AND EXHALATION VALVE ASSEMBLY

PRODUCT	PART NUMBER	QUANTITY
Whole Assembly (Housing and flow sensor)	1505-3848-000	1
Housing only (includes water trap and membrane)	1505-8568-000	1
Flow sensor only	1505-3231-000	1



Use the exhalation valve heater to prevent moisture from condensing in the expiratory flow sensor when a humidifier is used. The exhalation valve heater should be utilized when an active humidifier with a heated expiratory limb is used.

**EXHALATION VALVE HEATER**

1	Exhalation Valve Heater	M1200693
2	Cable (order separately)	M1188723

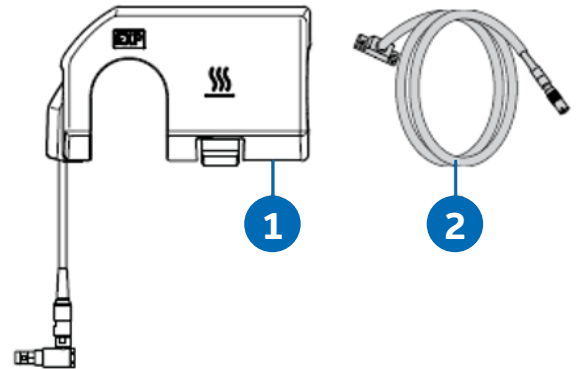

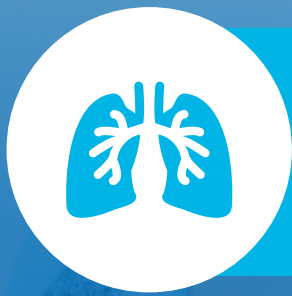

# SPIROMETRY

For measuring the respiratory gases and lung mechanics at the patient's airway, the products in the GE Healthcare patient spirometry range guarantee optimal performance in humid conditions. The D-lite+ and Pedi-lite+ flow sensors have hydrophilic surface and are intended for use in humid conditions.



D-LITE FLOW SENSORS						
SENSORS	PATIENT	USE	COLOR	PATIENT TIDAL VOLUME	PART NUMBER	QUANTITY
D-lite+	Adult	Disposable	Transparent	150-2000 ml	896952	50
D-lite		Reusable	Transparent yellow		733910-HEL	1
Pedi-lite+	Pediatric	Disposable	Transparent	5 - 300 ml	8001948	50
Pedi-lite		Reusable	Transparent yellow	15-300 ml*	73393	1

\*Measurement range 15 – 300 ml with E-COV, E-COVX, E-CAiOV, E-CAiOVX modules.

## DISPOSABLE SPIROMETRY TUBE

PRODUCT	COLOR	2M LENGTH	3M LENGTH	QUANTITY
Spirometry tube	Transparent Yellow	890031	884101	5

## DISPOSABLE SPIROMETRY KITS FOR HUMID CONDITIONS



PRODUCT	PATIENT TYPE	2M LENGTH	3M LENGTH	QUANTITY
<ul style="list-style-type: none"> <li>D-lite+ or Pedi-lite+ sensor</li> <li>Gas sampling line</li> <li>Spirometry tube</li> </ul>	Adult	8004381	8004382	20
	Pediatric	8002718	M1032634	50
<ul style="list-style-type: none"> <li>D-lite++ sensor</li> <li>Gas sampling line</li> <li>Spirometry tube</li> </ul>	Adult	2104297-001	2104297-002	20



D-lite++ sensor is designed to reduce the entry of water and other patient liquids to the gas sampling line and spirometry tubes.





# GAS MONITORING

GE Healthcare's gas sampling lines are validated and rigorously tested to ensure optimal performance on your GE Healthcare equipment. Water traps in the D-Fend™ range protect your monitors from moisture, contaminations and secretions.

D-Fend, D-Fend+, D-Fend Pro+ and Mini D-Fend water traps are specified for use with the following module

	E-CO	E-COV	E-COVX
D-fend+	X	X	X

	E-sCO	E-sCOV	E-sCOVX
D-fend Pro+	X	X	X

	E-miniC
Mini D-fend	X



WATER TRAPS			
PRODUCT	COLOR	PART NUMBER	QUANTITY
Mini D-Fend	Light Grey	8002174	10
D-fend Pro+	Green	M1200227	10
D-fend+	Green	881319-HEL	10

Recommended to Change water trap for each new patient, whenever the host device prompts you to do so, or every 24 hours.



GAS SAMPLING LINE, PVC/PE			
USE	LENGTH	PART NUMBER	QUANTITY
Disposable	2 m	2097307-001	10
	3 m	2097307-002	10
	6 m	2097307-003	5



AIRWAY GAS SAMPLING SET				
USE	PATIENT TYPE	LENGTH	PART NUMBER	QUANTITY
Disposable	Adult/Pediatric	2 m	8090121521	20
	Adult/Pediatric	3 m	8090121531	
	Infant	2 m	8090121522	

Airway Gas Adapters Sets are for ICU use only

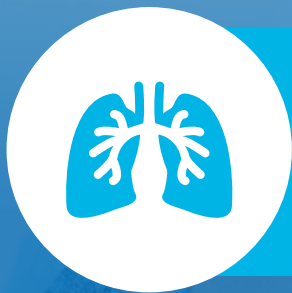

# NEBULIZER

The Aerogen® Professional Nebulizer System is a portable medical device for multiple-patient-use that is intended to aerosolize physician-prescribed solutions and suspensions for inhalation to patients on and off ventilation or other positive pressure breathing assistance.



## NEBULIZER REPLACEMENT PARTS

PRODUCT	PART NUMBER	QUANTITY
Aerogen nebulizer kit, includes Adult and Pediatric tee	1505-3846-000	1
Nebulizer cable	1505-5602-000	1
Aerogen Nebulizer filler cap	AG-AP1030	5
Aerogen Nebulizer head with filler cap	AG-AP1000	1
Aerogen Nebulizer tee-adapter with silicone plug, Adult	AG-AP1010	5
Aerogen Nebulizer tee-adapter with silicone plug, Pediatric	AG-AP1020	5
Aerogen Nebulizer, silicone plug	AG-AP1005	5
Adapter Kit Nebulizer Neonate	AG-AP1025	5
Tee Nebulizer Ped with Neonatal adapter kit	AG-AP1015	5

AG-AP1000



AG-AP1010

AG-AP1020



1505-5602-000



1505-3846-000



# FILTER

The Inspiratory Safety Guard (ISG) is required to connect the breathing circuit to the ventilator. Utilizing a mechanical hydrophobic filter, the ISG prevents patient gas from contaminating the inspiratory gas path of the ventilator.



VENTILATOR FILTER			
	PRODUCT	PART NUMBER	QUANTITY
Old version (soon to be EOL, still used for Russia)	Inspiratory Safety Guard	2066713-001	1
		2083208-001	10
New version	Inspiratory Safety Guard BCG	5830446	1
		5514015	10

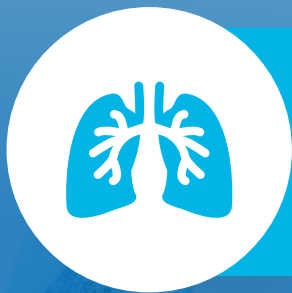

# PRESSURE CATHETERS

The intratracheal pressure catheter is only for pressure sensing. It cannot be used for suctioning the patient or for sampling gases. The catheter is for use only with endotracheal tubes having an internal diameter equal to or larger than 6.5 mm. The intratracheal pressure catheter is guided down a standard endotracheal tube. The catheter is connected to the auxiliary pressure port of the ventilator and attached to the patient airway. This single-patient-use catheter is purged using a bias flow to help ensure that it remains open.

Refer to the Instructions for Use supplied with the intratracheal pressure catheter for more information on the use and placement of the catheter.



## RESPIRATORY PRESSURE CATHETERS

DESCRIPTION	MACHINE COMPATABILITY	PART NUMBER	QUANTITY
Intratracheal Pressure Catheter	CARESCAPE™ R860 and Engström Ventilators	M1045564	10





GE Healthcare is a leading global medical technology and digital solutions innovator, GE Healthcare enables clinicians to make faster, more informed decisions through intelligent devices, data analytics, applications and services, supported by its Edison intelligence platform. With over 100 years of healthcare industry experience and around 50,000 employees globally, the company operates at the center of an ecosystem working toward precision health, digitizing healthcare, helping drive productivity and improve outcomes for patients, providers, health systems and researchers around the world. Follow us on Facebook, LinkedIn, Twitter and Insights , or visit our website [www.gehealthcare.co.uk](http://www.gehealthcare.co.uk) for more information.

[www.gehealthcare.co.uk](http://www.gehealthcare.co.uk)

Product may not be available in all countries and regions. Contact a GE Healthcare Representative for more information.

Data subject to change.

GE, the GE Monogram, D-Fend and D-Lite are trademarks of General Electric Company.

All other third-party trademarks are the property of their respective owners.

Reproduction in any form is forbidden without prior written permission from GE.

Nothing in this material should be used to diagnose or treat any disease or condition. Readers must consult a healthcare professional.

© 2021 General Electric Company. All rights reserved.

JB00433XE Rev 5 12/21

